

DESCRIPTION

Bi-directional rod wiper with shoulder for pneumatic cylinders

MATERIAL

Type: Polyurethane
 Designation: SEALPUR 93
 Hardness: 93 °ShA

MAIN FEATURES

The functions of the BCG bi-directional rod wiper are:

- to prevent introduction of dust, dirt and foreign matter into the system; this is achieved by a special wiper lip which produces a very effective cleaning action, prevents the development of scores, protects the guiding parts and extends the service life of the axial moving rod seals.
- to prevent the release of air from the cylinder ensuring a perfect seal; the asymmetric lips are designed to differentiate the behavior of the lips on the static and dynamic surfaces: the dynamic lip is rounded, flexible and more sensitive to pressure fluctuations; the static lip is longer and stronger to concentrate load against the static surface.

The material used to produce this seal is a polyurethane compound, specifically developed for the production of pneumatic seals, that ensures excellent properties on wear-resistance, extended service life and low permanent deformation.

- Simple groove design
- Geometry of the sealing lips is designed to operate with air lubricated and dry

- Low friction at all usage pressure
- Easy installation without expensive auxiliaries
- Excellent wear-resistance
- Extended service life

FIELD OF APPLICATION

Pressure	≤ 16 bar
Speed	≤ 1 m/s
Temperature	-35°C ÷ +80°C
Fluids	Air with or without lubrication, grease, mineral oils, non-aggressive gases, etc.

SURFACE ROUGHNESS

Dynamic surface	Ra ≤ 0.25 μm	Rt ≤ 2.5 μm
Static surface	Ra ≤ 0.8 μm	Rt ≤ 6.3 μm

LEAD-IN CHAMFERS

d	S _{MIN}
•less 20	3 mm
20÷50	4 mm
51÷150	5 mm
•over 150	6 mm

- to avoid damaging the sealing lips during installation, housing must have rounded chamfers. Sharp edges and burrs within the installation area of the seal must be removed

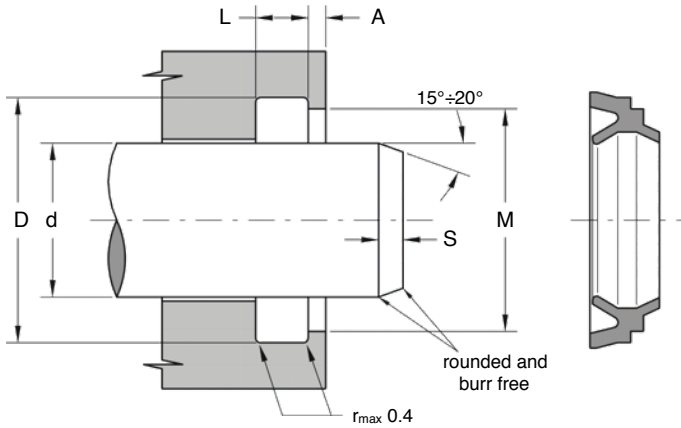

Part.	d f7	D H10	M ±0.1	L +0.15	A +0.1
BCG 4 8.1 2.8	4	8.1	6.7	3	0.8
BCG 6 11.1 3.3	6	11.1	9.1	3.6	1
BCG 8 14.1 3.3	8	14.1	12.1	3.6	1
BCG 10 16.1 3.8	10	16.1	14.1	4.2	1.2
BCG 12 18.1 3.8	12	18.1	15.5	4.2	1.2
BCG 16 24 3.6	16	24	22	4	2
BCG 18 26 3.6	18	26	24	4	2
BCG 20 28 3.6	20	28	26	4	2
BCG 25 33 3.6	25	33	31	4	2
BCG 28 36 3.6	28	36	34	4	2
BCG 30 38 3.6	30	38	36	4	2
BCG 35 43 3.6	35	43	41	4	2
BCG 36 44 3.6	36	44	42	4	2
BCG 42 50 3.6	42	50	48	4	2
BCG 60 68 3.6	60	68	66	4	2